

# Unitary Air Conditioner

## Duct Type

R410A

20.0/25.0/30.0kW  
5.7/7.1/8.5USRT40.0kW  
11.4USRT

▶ Adopting accurate controlling device, this unit can operate in a wide range of condition, including stable cooling operation in 52°C. Different air duct joints can reach the requirements of actual static pressure. Easy installation and flexible features enable this unit to be applied in hotel, plant, pleasure ground, etc.

- ◆ Quiet operation thanks to unique-designed structure.
- ◆ High reliability thanks to the electronic expansion valve which can ensure the unit reliably operates even in bad conditions.
- ◆ Flexible application: The max. length and drop height between indoor and outdoor units can reach up to 30m and 25m. The ESP of indoor unit can be customized to meet various requirements.
- ◆ Higher operation efficiency thanks to multistep partial load operation, having little effect on the electric network



Easy installation



Quiet design



Long life and washable filter



Wired remote control



Weekly timer (optional)

### Nominal Operating Condition

Item	Outdoor Condition		Indoor Condition	
	DB Temperature(°C)	WB Temperature(°C)	DB Temperature(°C)	WB Temperature(°C)
Cooling	35	24	27	19
Heating	7	6	20	15

Operation Range	Cooling	°C	21~43
	Heating	°C	-5~24



Model				Cooling only	—	NEW FG25/BNa-M	—	NEW FG40/BNa-M
				Heat pump	FGR20/BNa-M	FGR25/BNa-M	FGR30/BNa-M	FGR40/BNa-M
Characteristics of units	Capacity	Cooling	kW	20.0	24.5	30.0	39.5	
			RT	5.7	7.0	8.5	11.4	
		Heating*	kW	22.0	27.5	33.0	42	
			RT	6.3	7.8	9.4	12.2	
	Outdoor quantity		unit	1				
	Power supply		V-Ph-Hz	380-415V-3Ph-50Hz				
	Power input	Cooling	kW	8.4	9.8	11.0	15.8	
Heating*		kW	7.0	9.0	9.0	14		
Indoor unit	Airflow volume		m³/h	4000	4800	5500	7000	
			CFM	2380	2825	3230	4120	
	Esp default		Pa	90	110	200	150	
	Esp range		Pa	100~250	30~250	100~250	50~300	
	Sound pressure level		dB(A)	56	54	57	58	
	Outline dimension	W×D×H	mm	1463×799×389	1500×1000×500	1500×1000×500	1700×1100×650	
	Package dimension	W×D×H	mm	1540×880×400	1840×1200×673	1840×1200×673	1890×1460×835	
	Net weight		kg	86	150	156	215	
	Gross weight		kg	109	200	206	265	
Outdoor unit	Sound Pressure Level		dB(A)	65	66	67	69	
	Outline dimension	W×D×H	mm	1150×460×1350	1150×360×1600	974×566×1190	1290×880×1772	
	Package dimension	W×D×H	mm	1300×500×1370	1305×502×1715	990×880×1772	1370×980×1950	
	Net weight		kg	127	185	216	300	
	Gross weight		kg	137	200	266	330	
Connecting pipe diameter	Diameter	Liquid	inch	3/8	3/8	1/2	5/8	
		Gas	inch	3/4	1	9/8	9/8	
	Max. piping length		m	50	50	50	50	
	Max.height Diff.between IDU & ODU		m	30	30	30	30	
Loading quantity	40'GP/40'HQ			32/35	12/12	15/15	8/8	

\*For Heat Pump Unit only.

# Unitary Air Conditioner

## Duct Type

R22



20/25/30kW



40kW



50/60kW



55/65kW



- ◇ Quiet operation thanks to unique-designed structure.
- ◇ High reliability thanks to the electronic expansion valve which can ensure the unit reliably operates even in bad conditions.
- ◇ Flexible application: The max. length and drop height between indoor and outdoor units can reach up to 30m and 25m. The ESP of indoor unit can be customized to meets various requirements.
- ◇ Higher operation efficiency thanks to multistep partial load operation which has little impact on the electric network.



Easy installation



Quiet design



Long life and washable filter



Wired controller (standard)



Weekly timer (optional)

Nominal Operating Condition				
Item	Outdoor Condition		Indoor Condition	
	DB Temperature(°C)	WB Temperature(°C)	DB Temperature(°C)	WB Temperature(°C)
Cooling	35	24	27	19
Heating	7	6	20	15

Operation Range	Cooling	°C	21~43
	Heating	°C	-5~24



Model	Heat pump			FGR50/B(2)-G	FGR55/B-G	FGR60/B(2)-G	FGR65/B-G
	Cooling only			FG50/B(2)-G	FG55/B-G	FG60/B(2)-G	FG65/B-G
Characteristics of unit	Capacity	Cooling	kW	50	55	60	65
			RT	14.2	15.6	17.1	18.5
		Heating	kW	53	60	64	70
			RT	15.1	17.1	18.2	19.9
	Outdoor quantity		Unit	2	1	2	1
	Power supply		V-Ph-Hz	380V-3Ph-50Hz			
	Motor power input	Cooling	kW	20.7	21.5	24.5	27.5
		Heating	kW	17.7	19.5	20.5	22.8
Indoor unit	Air flow volume		m³/h	9000		11000	
			CFM	5297		6474	
	Standard Esp		Pa	160			
	Esp range		Pa	100~200			
	Sound pressure level		dB(A)	60		62	
	Outline dimension	W×D×H	mm	1900×1100×700		1900×1100×850	
	Package dimension	W×D×H	mm	2090×1460×885		2090×1460×1040	
	Net Weight		kg	315		325	
Gross weight		kg	365		375		
Outdoor unit	Sound pressure level		dB(A)	70		71	
	Outline dimension	W×D×H	mm	2×(990×880×1772)	1980×920×1760	2×(990×880×1772)	1980×920×1760
	Package dimension	W×D×H	mm	2×(1162×980×1950)	2152×980×1950	2×(1162×980×1950)	2152×980×1950
	Net Weight		kg	2×230	550	2×250	550
	Gross weight		kg	2×260	580	2×280	580
Connecting pipe	diameter	Gas	inch	2×1-1/8	1-5/8	2×1-1/8	1-5/8
		Liquid	inch	2×5/8	7/8	2×5/8	7/8
	Max. piping length		m	70			
	Max.height Diff.between IDU&ODU		m	30			



Model	Heat pump			FGR20/C-M	FGR25/C-M	FGR30/C-M	FGR40/C-M
	Cooling only			FG20/C-M	FG25/C-M	FG30/C-M	FG40/C-M
Characteristics of unit	Capacity	Cooling	kW	19.5	24.5	29.5	38
			RT	5.5	6.9	8.4	10.8
		Heating	kW	22.5	27.5	32.5	41
			RT	6.4	7.8	9.3	11.7
	Outdoor quantity		Unit	1			
	Power supply		V-Ph-Hz	380V-3Ph-50Hz			
	Motor power input	Cooling	kW	8.5	10.2	12.1	16
		Heating	kW	7.3	9	10.1	13.5
Indoor unit	Air flow volume		m³/h	4000	4800	5500	7000
			CFM	2354	2825	3237	4120
	Standard Esp		Pa	90	110	130	150
	Esp range		Pa	30~250	30~250	30~250	50~300
	Sound pressure level		dB(A)	54	54	57	58
	Outline dimension	W×D×H	mm	1500×1000×500	1500×1000×500	1500×1000×500	1700×1100×650
	Package dimension	W×D×H	mm	1840×1200×673	1840×1200×673	1840×1200×673	1890×1460×835
	Net Weight		kg	140	150	150	215
Outdoor unit	Gross weight		kg	175	185	200	265
	Sound pressure level		dB(A)	66	66	67	69
	Outline dimension	W×D×H	mm	1150×360×1350	1150×360×1600	990×880×1772	1290×880×1772
	Package dimension	W×D×H	mm	1305×502×1460	1305×502×1715	1162×980×1950	1370×980×1950
	Net Weight		kg	140	185	250	300
Connecting pipe	Gross weight		kg	158	200	280	330
	diameter	Gas	inch	5/8	5/8	5/8	5/8
		Liquid	inch	9/8	9/8	9/8	11/8
	Max. piping length		m	50			
	Max.height Diff.between IDU&ODU		m	30			

# Unitary Air Conditioner

## Rooftop Air Conditioner

R22



3.0/4.0USRT



5.0USRT



8.0/10.0USRT



15.0USRT



20.0/25.0/30.0USRT

wired controller  
(Optional)

Combining cooling, heating, air supply rooftop heat pump unit is an integral unit with complete air system, whose structure is compact and capacity is huge. The adjustment to the unit is very convenient and installation of the unit is easy, which save expenditure and maintenance cost. It is applicable to metallurgy, chemical and electric engineering industries, as well as places where comfortable air is required, such as hospital, market, restaurant and bar, especially for water deficient regions and the place where water system is not convenient to be installed.



- ◇ Easy installation.
- ◇ Compact design.
- ◇ Long life and washable filter.
- ◇ Wired remote controller(optional).



Easy installation



Compact design



Long life and washable filter

Nominal Operating Condition

Item	Indoor Condition		Outdoor Condition	
	DB Temperature(°C)	WB Temperature(°C)	DB Temperature(°C)	WB Temperature(°C)
Cooling	27	19	35	24
Heating	20	15	7	6

Operation Range	Cooling	18~52°C
	Heating	-7~24°C

## Cooling Only



Model		GK-C03TC1AK	GK-C04TC1AM	GK-C05TC1AM	GK-C08TC1AM	GK-C10TC1AM
Cooling Capacity	RT	3	4	5	8	10
Auxiliary Heater Capacity(Optional)	kW	5/10	5/10	5/10	10/15/20	10/15/20
Power supply	V-Ph-Hz	220V-1Ph-50Hz	380-415V-3Ph-50Hz	380-415V-3Ph-50Hz	380-415V-3Ph-50Hz	380-415V-3Ph-50Hz
Power Input	kW	4.7	5.4	7.2	11.8	15.1
Dehumidifying	l/h	3.6	4.5	6.2	7.5	10.0
Air Flow	m³/h	1630	1750	3520	5500	7500
	CFM	962	1032	2076	3245	4425
External Statics Pressure	Pa	25	25	75	100	100
Refrigerant Charge Volume	kg	1.8	3.5	4	3.1+2.7	4.3×2
Sound Pressure Level	dB(A)	65	67	67	70	73
Outline Dimension	W×D×H	mm	1345×1055×640	1345×1055×790	2006×1436×1117	2006×1436×1117
Package Dimension	W×D×H	mm	1392×1100×665	1392×1100×815	2046×1466×1152	2046×1466×1152
Condensation Water Pipe	inch	3/4	3/4	3/4	3/4	3/4
	mm	19.05	19.05	19.05	19.05	19.05
Net Weight/Gross Weight	kg	185/190	185/190	205/215	455/485	470/500
Loading quantity	20'GP/40'GP/40'HQ	24/48/64	24/48/64	16/32/48	8/16/16	8/16/16



Model		GK-C15TC1AM	GK-C20TC1AM	GK-C25TC1AM	GK-C30TC1AM
Cooling Capacity	RT	15	20	25	30
Auxiliary Heater Capacity(Optional)	kW	20/25/30	20/25/30	20/25/30	20/25/30
Power supply	V-Ph-Hz	380-415V-3Ph-50Hz	380-415V-3Ph-50Hz	380-415V-3Ph-50Hz	380-415V-3Ph-50Hz
Power Input	kW	24.5	27.0	33.5	40.0
Dehumidifying	l/h	15.6	15.6	18.5	30.0
Air Flow	m³/h	10000	14000	14500	15500
	CFM	5900	8260	8534	9144
External Statics Pressure	Pa	200	200	250	250
Refrigerant Charge Volume	kg	4.5 + 5.4	10 + 10	12 + 12	13 + 12
Sound Pressure Level	dB(A)	75	78	78	81
Outline Dimension	W×D×H	mm	2205×1610×1190	2870×2120×1375	2870×2120×1375
Package Dimension	W×D×H	mm	2245×1640×1225	2950×2198×1555	2950×2198×1555
Condensation Water Pipe	inch	3/4	1	1	1
	mm	19.05	25.40	25.40	25.40
Net Weight/Gross Weight	kg	640/679	1005/1170	1049/1214	1143/1308
Loading quantity	20'GP/40'GP/40'HQ	3/7/14	1/4/4	1/4/4	1/4/4

New



Model			GK-H05TC1AM <sup>New</sup>	GK-H08TC1AM <sup>New</sup>	GK-H10TC1AM <sup>New</sup>	GK-H15TC1AM <sup>New</sup>
Cooling Capacity	RT		5	8	10	15
Heating Capacity	RT		5	8	10	15
Auxiliary Heater Capacity(Optional)	kW		5/10	10/15/20	10/15/20	20/25/30
Power supply	V-Ph-Hz		380-415V-3Ph-50Hz	380-415V-3Ph-50Hz	380-415V-3Ph-50Hz	380-415V-3Ph-50Hz
Power Input	Cooling	kW	7.2	11.8	15.1	24.5
	Heating	kW	6.5	10.5	14.3	22.5
Dehumidifying	l/h		6.2	7.5	10.0	15.6
Air Flow	m³/h		3520	5500	7500	10000
	CFM		2076	3245	4425	5900
External Statics Pressure	Pa		75	100	100	200
Refrigerant Charge Volume	kg		4	3.1+2.7	4.3×2	4.5+5.4
Sound Pressure Level	dB(A)		67	70	73	75
Outline Dimension	W×D×H	mm	1345×1055×790	2006×1436×1117	2006×1436×1117	2205×1610×1190
Package Dimension	W×D×H	mm	1392×1100×815	2046×1466×1152	2046×1466×1152	2245×1640×1225
Condensation Water Pipe	inch		3/4	3/4	3/4	3/4
	mm		19.05	19.05	19.05	19.05
Net Weight/Gross Weight	kg		210/220	460/490	475/505	645/684
Loading quantity	20'GP/40'GP/40'HQ		16/32/48	8/16/16	8/16/16	3/7/14



Model			GK-H20TC1AM <sup>New</sup>	GK-H25TC1AM <sup>New</sup>	GK-H30TC1AM <sup>New</sup>
Cooling Capacity	RT		20	25	30
Heating Capacity	RT		20	25	30
Auxiliary Heater Capacity(Optional)	kW		20/25/30	20/25/30	20/25/30
Power supply	V-Ph-Hz		380-415V-3Ph-50Hz	380-415V-3Ph-50Hz	380-415V-3Ph-50Hz
Power Input	Cooling	kW	27.0	33.5	40.0
	Heating	kW	24.8	31.5	37.6
Dehumidifying	l/h		15.6	18.5	30.0
Air Flow	m³/h		14000	14500	15500
	CFM		8260	8534	9144
External Statics Pressure	Pa		200	250	250
Refrigerant Charge Volume	kg		10+10	12+12	13+12
Sound Pressure Level	dB(A)		78	78	81
Outline Dimension	W×D×H	mm	2870×2120×1375	2870×2120×1375	2870×2120×1375
Package Dimension	W×D×H	mm	2950×2198×1560	2950×2198×1555	2950×2198×1555
Condensation Water Pipe	inch		1	1	1
	mm		25.40	25.40	25.40
Net Weight/Gross Weight	kg		1010/1175	1054/1219	1148/1313
Loading quantity	20'GP/40'GP/40'HQ		1/4/4	1/4/4	1/4/4

# Unitary Air Conditioner

## Water Cooled Package R22



32.0/49.0/65.0kW



80.0/98.0/116.0/130.0/145.0/196.0kW

- ▶ Gree water cooled package has unitary and compact structure , high efficiency components and parts and high energy efficiency , human friendly operation interface, various functions which ensure safe, reliable, stable and energy saving operation, and flexible installation. It is suitable for the workshop, shop, supermarket, hotel, office and so on.



- ◇ Ideal for workshop, shop, supermarket, hotel, office.
- ◇ Easy installation.
- ◇ High efficiency.
- ◇ Quiet operation.
- ◇ With low-noise fan motor and hermetic scroll compressor with sound insulation system.
- ◇ Completed protection.
- ◇ Microprocessor intelligent control.
- ◇ Fresh air entry reserved.
- ◇ Reserved interface for water pump, cooling tower.
- ◇ Scroll compressor.
- ◇ Shell and tube condenser.
- ◇ LCD control panel.
- ◇ Centralized wired remote control(optional).
- ◇ Long distance control(optional).



Easy installation



Energy saving



Quiet design

Item	Water Side		Air Side	
	Inlet Water Temperature(°C)	Outlet Water Temperature(°C)	DB Temperature(°C)	WB Temperature(°C)
Cooling	30	35	27	19

Item	Operating Range	
	Outlet Water Temperature(°C)	Temperature Difference between Inlet&Outlet(°C)
Cooling	18~46	4~7



Model		Cooling only	L32/C-M	L32S/C-M	L49S/C-M	L65S/C-M	L80S/C-M	
Characteristics of unit	Cooling capacity	kW	32	32	49	65	80	
	Optional heating capacity*	kW	15/18	15/18	18/22/27	18/22/27	22/27/36	
	Air flow volume	m³/h	6000	6000	9000	11000	14000	
		CFM	3536	3536	5303	6482	8250	
	ESP	Pa	0	75	75	100	100	
	Control temp.	℃	16～30±(2)					
	Sound pressure level	dB(A)	≤65	≤65	≤69	≤70	≤71	
	Power supply	-	380V -3Ph-50Hz					
	Cooling rated power	kW	8.8	9.3	14.2	18.7	22.5	
	Rated current	A	15.5	16.2	25.8	33.8	40.5	
Power cord	mm²	6	6	25	35	35		
Refrigeration system	Compressor	Type	Hermetic Scroll Compressor					
		Quantity	pc	1	1	2	2	2
	Condenser	Type	Shell and tube exchanger(High Efficiency Heat-Change Tube)					
		Water flow volume	m³/h	7.5	7.5	11.0	14.5	18.6
			CFM	4.41	4.41	6.47	8.53	10.95
		Water resistance	kPa	8.1	8.1	19.0	16.0	21.0
		Connection pipe	Inch	2	2	2	2-1/2	2-1/2
	Evaporator	Type	Finned Tube					
		Segment pitch	mm	1.8	1.8	1.6	1.6	1.8
	Refrigeration	Type	R22					
Throttling way		Throttle Capillary Tube						
Charge volume		kg	5.7	5.7	6.8+6.3	7+7.2	9.4+9.4	
Ventilation system	Internal fan	Type	Centrifugal Fan					
		Drive	Belt Driving					
		Power	kW	0.75	1.50	2.20	4.00	4.00
	Filter	-	Nylon Air Filter					
Control model		-	Control By Microcomputer					
Drainage pipe dimension	Condensing water(Upper pipe)		G1(ID)	G1(ID)	G1(ID)	G1(ID)	Φ32mm(OD)	
	Chassis water(Lower pipe)		G1(ID)	G1(ID)	G1(ID)	G1(ID)	G3/4(OD)	
Dimension	Outline(W×D×H)	mm	1635×790×2258	1635×790×1980	1635×790×1980	1635×790×1980	1974×1220×1960	
	Package(W×D×H)	mm	1715×870×2338	1715×870×2060	1715×870×2060	1715×870×2060	2054×1300×2040	
Weight	Net weight	kg	475	456.5	616	630	750	
	Gross weight	kg	480	461.5	621	635	755	
Loading quantity	40'GP/40'HQ		13/13	13/13	13/13	13/13	9/9	

\*is for the date of the unit with electric heater

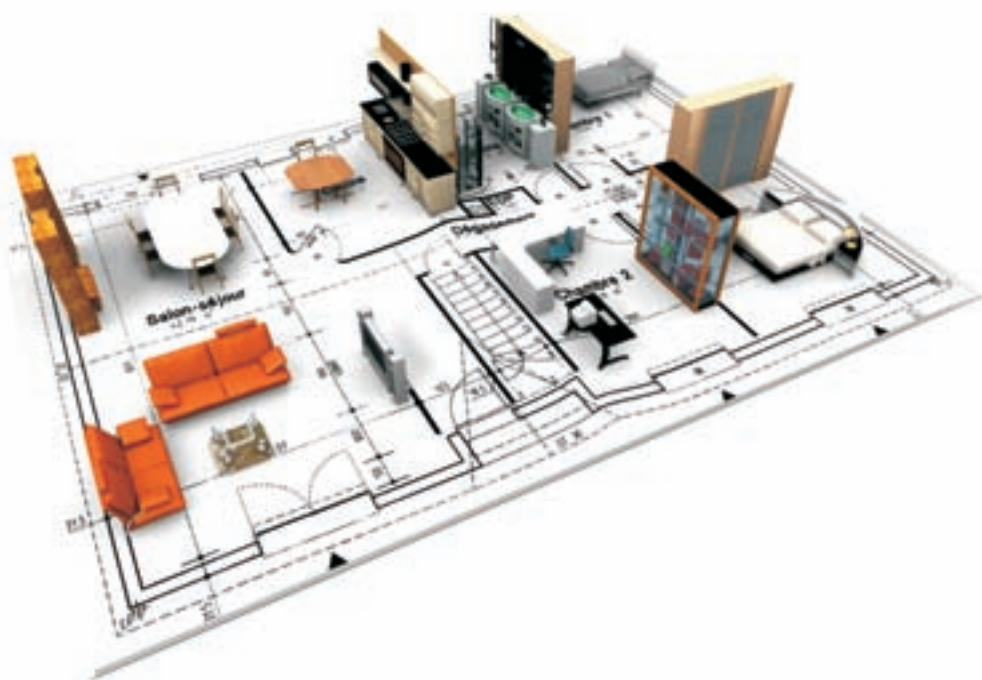



Model			Cooling only	L98S/C-M	L116S/C-M	L130S/C-M	L145S/C-M	L196S/C-M
Characteristics of unit	Cooling capacity		kW	98	116	130	145	196
	Optional heating capacity*		kW	22/27/36	30/36/45	30/36/45	30/36/45	45/54/63
	Air flow volume	m³/h	16000	20000	22000	23000	32000	
		CFM	9428	11786	12964	13537	18857	
	ESP		Pa	115	140	140	140	190
	Control temp.		℃	16-30±(2)				
	Sound pressure level		dB(A)	≤72	≤74	≤74	≤76	≤78
	Power supply		-	380V- 3Ph-50Hz				
	Cooling rated power		kW	29.0	32.2	38.2	40.1	55.4
	Rated current		A	51.8	60.2	63.2	71.4	97.8
Power cord		mm²	50	70	95	95	120	
Refrigeration system	Compressor	Type	-	Hermetic Scroll Compressor				
		Quantity	pc	3	3	4	3	6
	Condenser	Type	-	Shell and tube exchanger(High Efficiency Heat-Change Tube)				
		Water flow volume	m³/h	21.5	24.0	26.9	31.2	44.1
			CFM	12.65	14.12	15.83	18.36	25.96
		Water resistance	kPa	34.0	49.0	51.0	42.0	55.5
		Connection pipe	Inch	2-1/2	2-1/2	3	3	3
	Evaporator	Type	-	Finned Tube				
		Segment pitch	mm	1.8	1.8	2.0	1.8	1.8
	Refrigeration	Type	-	R22				
Throttling way		-	Throttle Capillary Tube					
Charge volume		kg	4.9+6.2+6	3×13.5	2×15	9.1+2×8.4	3×13	
Ventilation system	Internal fan	Type	-	Centrifugal Fan				
		Drive	-	Belt Driving				
		Power	kW	5.50	5.50	7.50	11.00	11.00
	Filter		-	Nylon Air Filter				
Control model			-	Control By Microcomputer				
Drainage pipe dimension	Condensing water(Upper pipe)			Φ32mm(OD)	Φ32mm(OD)	Φ32mm(OD)	Φ32mm(OD)	Φ32mm(OD)
	Chassis water(Lower pipe)			G3/4(OD)	G3/4(OD)	G3/4(OD)	G3/4(OD)	G3/4(OD)
Dimension	Outline(W×D×H)		mm	1974×1220×1960	2325×1220×1960	2325×1220×1960	2325×1220×1960	2670×1220×2160
	Package(W×D×H)		mm	2054×1300×2040	2405×1300×2040	2405×1300×2040	2405×1300×2040	2750×1300×2240
Weight	Net weight		kg	965	1165	1070	1260	1520
	Gross weight		kg	970	1170	1075	1265	1525
Loading quantity	40'GP/40'HQ			9/9	4/4	4/4	4/4	4/4

\*is for the date of the unit with electric heater

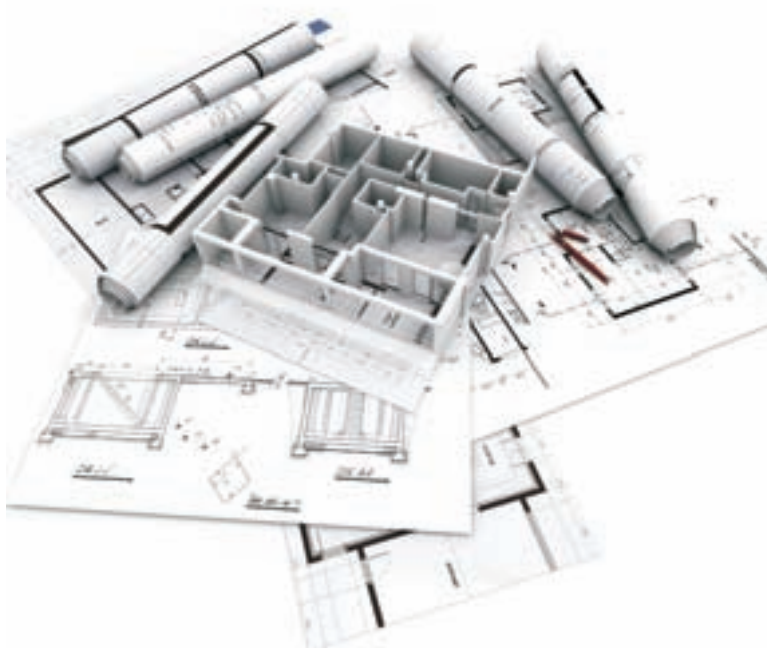

# Unitary Air Conditioner

## Air Cooled Package

R22

Outdoor unit



28.0kW

Indoor unit



- ◇ High efficiency and energy saving
- ◇ Stable operation
- ◇ Overall protections
- ◇ Quiet operation
- ◇ Microcomputer control



Humanized sleep function



Wide angle air outlet system



24 hours timer



Rapid cooling (heating)



Low voltage startup

Nominal Operating Condition

Item	Outdoor Condition		Indoor Condition	
	DB Temperature(°C)	WB Temperature(°C)	DB Temperature(°C)	WB Temperature(°C)
Cooling	35	24	27	19
Heating	7	6	20	15

Operation Range	Cooling	°C	21~43
	Heating	°C	-5~21



Model	Heat pump			-	RF28W/J100-M	RF28WY/B-M
	Cooling			LF28W/J100-M	-	-
Characteristics of unit	Capacity	Cooling	kW	28	28	28
			RT	7.96	7.96	7.96
		Heating	kW	-	30	30
			RT	-	8.53	8.53
	Power supply		V-Ph-Hz	380-415V-3Ph-50Hz	380-415V-3Ph-50Hz	380-415V-3Ph-50Hz
	Rated power input	Cooling	kW	11.5	11.5	11.5
Heating		kW	-	10.0	10.0	
Indoor unit	Air flow volume		m³/h	4000		
			CFM	2354		
	Sound pressure level		dB(A)	64		
	Outline dimension	W×D×H	mm	1200×400×1850		
	Package dimension	W×D×H	mm	1350×510×1970		
	Net Weight		kg	150		
	Gross weight		kg	200		
	Outdoor unit	Sound pressure level		dB(A)	68	
Outline dimension		W×D×H	mm	930×770×1670		
Package dimension		W×D×H	mm	1030×850×1850		
Net Weight		kg	240			
Gross weight		kg	270			
Connecting pipe	diameter	Gas	inch	1-1/8		
		Liquid	inch	5/8		
	Max. piping length		m	30		
	Max.height Diff.between IDU&ODU		m	25		
Loading quantity	40´GP/40´HQ			13/13		

## VRF Outdoor Units

